

Selection of technologies used with in ELBA, a.s.:

PLASMA SHEET CUTTING
STEEL TUBES & BARS BENDING
COLD & HOT FORMING
ALUMINIUM & STEEL HEAT TREATMENT
ALUMINIUM & STEEL WELDING
ALUMINIUM & STEEL HOT PROCESSING
CUTTING & DRILLING OPERATIONS
HOT-DIP AND ELECTRO GALVANIZING
COPPER ALLOY PLASMA DEPOSITION
CNC MACHINING

ELBA, a.s. holds EN ISO 9001 and EN ISO 14001 certificates since 1995.
The Testing Laboratory holds ISO/IEC 17025.



references

Austria, Bulgaria, Czech Republic,
Croatia, Denmark, Egypt, Estonia,
Finland, France, Germany, Great Britain,
Hungary, Lithuania, Netherlands, Poland,
Serbia, Slovakia, Switzerland, Vietnam

ELBA, a. s.

Československej armády 264/58
967 01 Kremnica
Slovakia

Tel: +421 45 6704 351
+421 45 6704 353
+421 45 6704 111

E-mail: export@elba.sk
www.elba.sk



ELBA

SUBSTATION ACCESSORIES

- CLAMPS FOR BOLTS
- CLAMPS FOR CIRCULAR BASEMENT
- T-CLAMPS
- FLAT CLAMPS
- EARTHING POINTS – SPACERS
- FIXING COMPONENTS
- VARIOUS EQUIPMENT

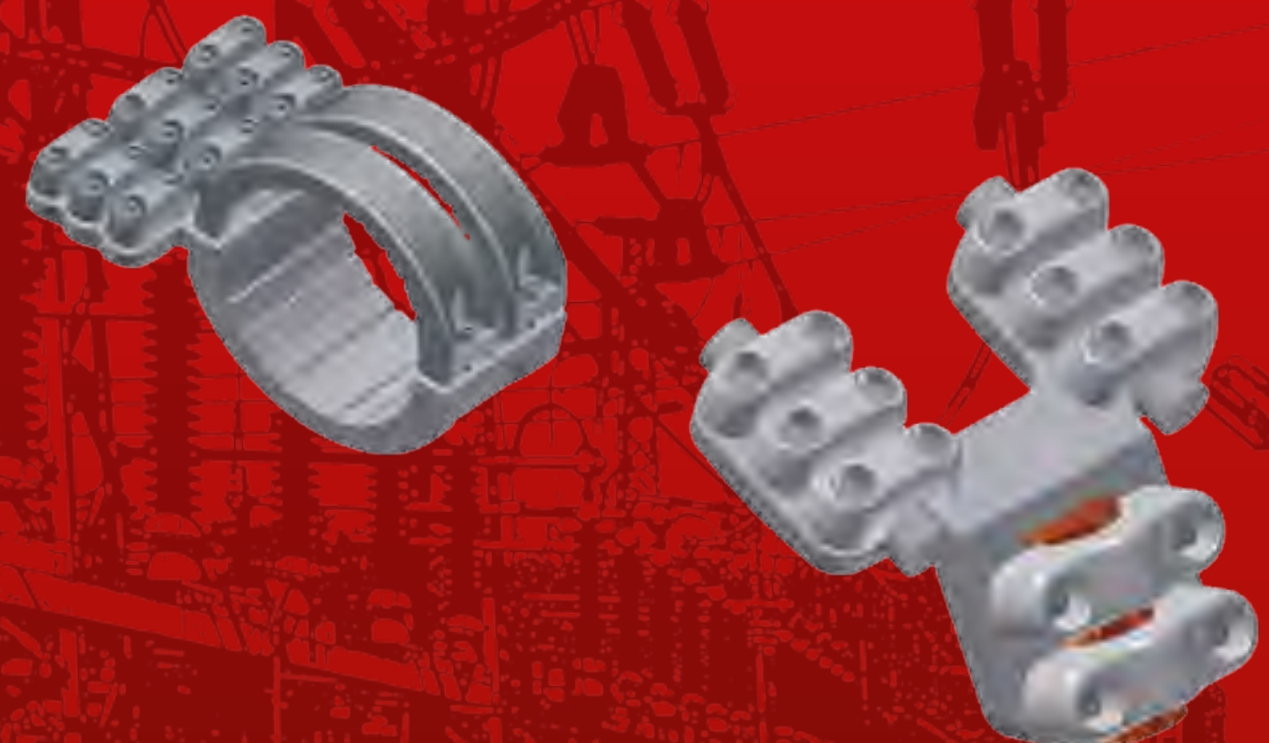

ELBA, a. s., an engineering company established in Kremnica (Slovakia), launched its manufacturing operations in 1950.

Overhead Lines Fittings Division is the biggest out of 4 company's divisions and produces hardware fittings for overhead transmission lines, connectors and fittings for HV, VHV and EHV substations, as well as fittings for railway tractions.

Substation accessories form crucial part of the company's product portfolio. These are used both in high voltage and ultra high voltage substations and might be divided into seven groups according to the use of the fittings.

Large stocks of high-quality materials such as aluminum, steel, copper in the form of sheets, rods and tubes enable the company to respond flexibly to customers' requirements within the required lead times. Their quality and certification of each supplier is a matter of course. The inspection exercised on the material input is a guarantee of output product quality.

The combination of the wide product portfolio and various technologies requires huge number of specialized tools and fixtures. This requirement is met by a close cooperation with the Tooling Division, which provides customized design of tools and allows flexible response to new product requirements.

Manufactured products are tested in the own accredited independent testing laboratory.

Overhead Lines Fittings Division successfully implemented integrated quality management system and 5S Methodology of workplace organization.

Team of qualified professionals is ready to provide highly-professional approach and optimal technical solutions to satisfy specific customer requirements.

